

COORDINATE DATUM IS MAP GRID OF AUSTRALIA (MGA94, ZONE 56)

PSM	COORDINATES			DESCRIPTION
	EASTING	NORTHING	HEIGHT	
52286	537040.375	6905940.380	30.093	Brass Plaque
3123	537113.052	6906700.733	18.798	MR4 1K S/P
110693	537932.691	6906739.279	19.577	
115339	537479.858	6907521.177	20.234	
74657	537737.754	6907454.304	19.472	Brass Plaque

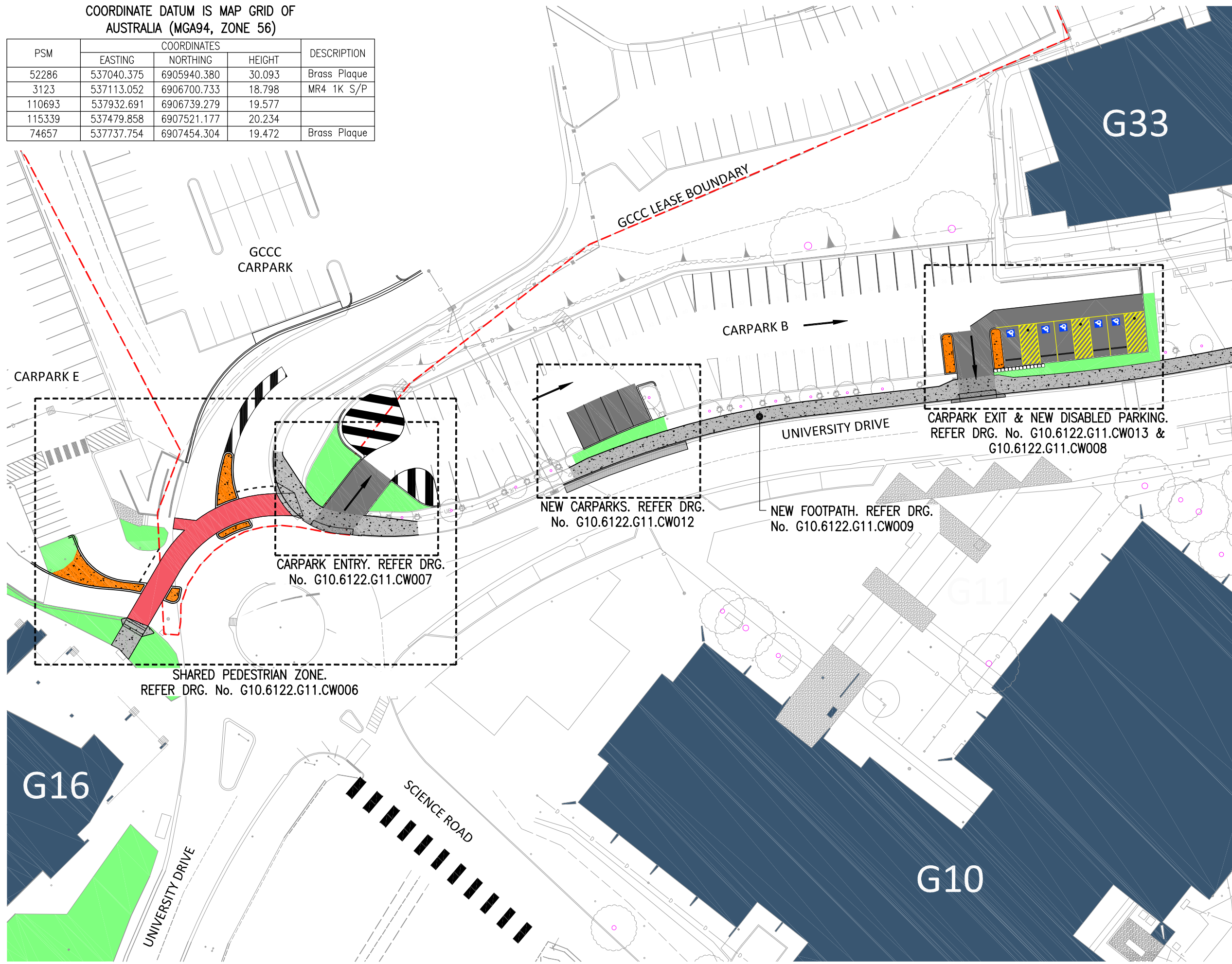

LAYOUT PLAN

NOTES
 VERIFY ALL DIMENSIONS AND CHECK LEVELS ON SITE BEFORE COMMENCING WORK. DO NOT SCALE FROM THE DRAWING. THIS DRAWING IS COPYRIGHT AND REMAINS THE PROPERTY OF THE UNIVERSITY AND SHALL NOT BE REPRODUCED OR COPIED IN ANY FORM OR BY ANY MEANS WITHOUT THE WRITTEN PERMISSION OF THE UNIVERSITY.

AMENDMENTS				
REV	DATE	DESCRIPTION	DRN	CKD
0	17/01/12	TENDER ISSUE	LCS	GEL

THIS DRAWING TO BE READ IN CONJUNCTION WITH G10.6122.G11.CW002, GENERAL NOTES

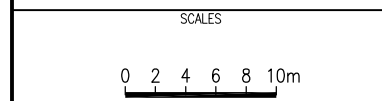

Dimensions shown in metres unless noted otherwise

consulting geleon
 ENGINEERS, MANAGERS, PLANNERS
 ABN 79 166 161 797
 Suite 2B, Cotton Place, 19 Cotton Street Nerang
 PO Box 454 Nerang Qld 4211
 tel +61 7 5596 0020
 fax +61 7 5596 0060
 email admin@geleon.com.au
 www.geleon.com.au

Engineering Certification

 G Lerch
 GELEON PROJECT No. 6018 RPEQ No. 7382

Griffith UNIVERSITY

PLANNING, DESIGN & CONSTRUCTION DIVISION
 CAMPUS LIFE
 NATHAN CAMPUS
 170 KESSELS ROAD NATHAN BRISBANE QLD. 4111
 PH: (07) 3735 7111
 FAX: (07) 3735 7746

CAMPUS: GOLD COAST

PROJECT:
 UNIVERSITY DRIVE AND CARPARK 'B'
 IMPROVEMENT WORKS

DISCIPLINE: CIVIL

DRAWING TITLE:
 LAYOUT PLAN

DATE: 17/01/12	SCALE: 1:250	DESIGNED BY: K Ostrofski
GU PROJECT MANAGER: GRANT BARTHOLOMEW		DRAWN BY: L Seoney
CAD FILE NAME: G10.6122.G11.CW003.DWG		APPROVED BY: G Lerch

	GU PROJECT NO. G106122	SHEET NO. 3 OF 13
	DRAWING NO. G10.6122.G11.CW003	REVISION 0

P:\M018 (2) - Campus & Research\Drawings\Nathan\G10.6122.G11.CW003.dwg Printed on 17 January 2012 8:40:52 AM Plot Scale=1:1 on US28x41